

Mesh Boolean Library

Mesh Boolean Library

Mesh Boolean is a C++ based library developed for performing Boolean operations of triangular meshes. This library takes the input meshes and performs boolean operations such as Unite, Subtract and Intersect on the meshes.

Mesh Boolean Salient Features

- ✎ Works with Open and Closed meshes
- ✎ Supports Union, Subtract (Cut) and Intersect
- ✎ Handles overlapping regions very well
- ✎ Can handle large meshes with millions of triangles
- ✎ Solves situations where slivers are created as results
- ✎ Fast output and can be used for simulation
- ✎ Flexible licensing scheme

Mesh Boolean Library

Unite

Cut

Intersect

Mesh Boolean Benefits

- ✎ A robust library that is well tested in variety of domains
- ✎ Can handle very large meshes, so extremely scalable
- ✎ Has very small memory footprint
- ✎ Very fast and can be used for simulation purposes
- ✎ Backed by a capable and dedicated development team

Technical Features

- ✎ Developed in C++
- ✎ Available as lib or dll
- ✎ Win 32 and 64 bit compatible
- ✎ Small memory footprint

Input Meshes

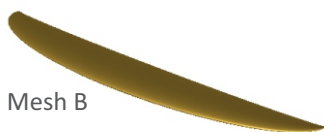

Easy to Integrate

- ✎ Very easy to integrate into your application
- ✎ Intuitive and user friendly APIs
- ✎ Source code samples to help you integrate
- ✎ Several data exchange APIs make it simple to transfer data to and from our library
- ✎ We would be glad to offer integration services

Output Meshes

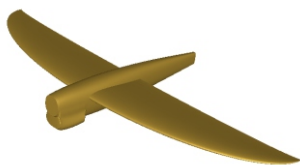

Union Operation

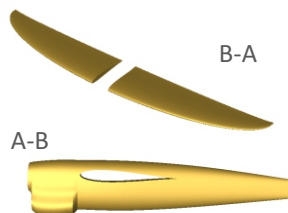

Subtract Operation



Intersection Operation

Data Courtesy: www.devcad.com

Evaluation Version : Please write to contact@pre-scient.com.

Mesh Boolean Library FAQs

What is Mesh Boolean Library and what does it do?

Mesh Boolean Library is a C++ based library developed for performing Boolean operations on triangular meshes. This library takes the input meshes and performs the Boolean operations such as (Unite, Subtract, Intersect). The library can handle meshes ranging from small to very large and produces good results. The library is available in DLL form and can be easily integrated into any application

What are the domains in which Mesh Boolean Library could be used?

Mesh Boolean library is a domain neutral library. This is currently used by our customers in variety of domains like Automotive, Healthcare, CAM simulation, Geology, 3D Printing.

How stable and accurate is Mesh Boolean Library?

Mesh Boolean library produces very accurate results and is very stable with robust exception handling mechanism built into it. In addition our development team is always working on enhancing the functionality and adding more features.

How do I know if Mesh Boolean Library is good for my application?

You could send a mail to contact@pre-scient.com and we will send you the Mesh Boolean Library SDK along with a sample program to help you integrate Mesh Boolean Library into your application. You could use our evaluation license for up to 90 days.

Alternately, we would be happy to work on your data and generate the results for you, of course at no cost or obligation to you.

What is the price and what are the licensing options?

Please send a mail to contact@pre-scient.com and we will get in touch with you with all the details. For Mesh Boolean Library we offer Perpetual licensing as well as Annual Subscription model.

How do I get support?

We offer an email and phone based support for our customers. Support is just a mail/call away.

Could you help me with integrating Mesh Boolean Library into my application?

We would be very glad to take the responsibility of integrating Mesh Boolean Library into your application. However this will be at a nominal extra charge.

